



## Pro Wall Chimney Hoods

With standard features like heat sentry and dual setting halogen lighting, Wolf Pro wall chimney hoods provide the ultimate in ventilation. Pro wall chimney hoods are available in four widths and all have the classic stainless steel finish. The Pro wall chimney hood installed with an optional 6", 12", 18" or 24" classic stainless steel duct cover completes the chimney design. With the Pro wall chimney hood you also have the option of a decorative rail.



Model PWC362418 shown.

### Features

- Classic stainless steel finish
- Optional classic stainless steel duct cover, available as a sales accessory, completes the chimney design
- Rail (R) models feature a classic stainless steel decorative rail
- Heavy-duty, 16-gauge brushed stainless steel with continually welded seams, hemmed edges and sides
- Stainless steel enclosed liner
- Recessed easy-access controls
- Infinite-speed blower control
- Heat sentry feature automatically turns unit on when heat is sensed and automatically adjusts blower speed
- Halogen lighting with two settings
- Removable, dishwasher-safe, restaurant-grade stainless steel baffle filters
- Transition with backdraft damper included



Recessed Controls

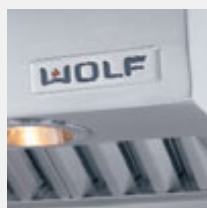

Baffle Filters

### Model Options

| Model         | PWC362418 | PWC422418 | PWC482418 | PWC542418 |
|---------------|-----------|-----------|-----------|-----------|
| Overall Width | 36"       | 42"       | 48"       | 54"       |

Model numbers are for hoods without decorative rail, add (R) to the model number for rail models.

### Accessories

- Platinum or brass decorative rail and stand-offs
- 38" high classic stainless steel backsplash with or without warming racks
- 6", 12", 18" and 24" classic stainless steel duct covers

Accessories are available through your Wolf dealer. To obtain local dealer information, visit the Showroom Locator section of our website, [wolfappliance.com](http://wolfappliance.com).

### Blower Options

- 600, 900 and 1200 CFM internal blowers
- 1100 CFM in-line blowers
- 900, 1200 and 1500 CFM remote blowers

Pro wall chimney hoods are sold as a shell only. An internal, in-line or remote blower is required. For blower recommendations, visit our website, [wolfappliance.com](http://wolfappliance.com).



## Pro Wall Chimney Hoods

### Overall Dimensions

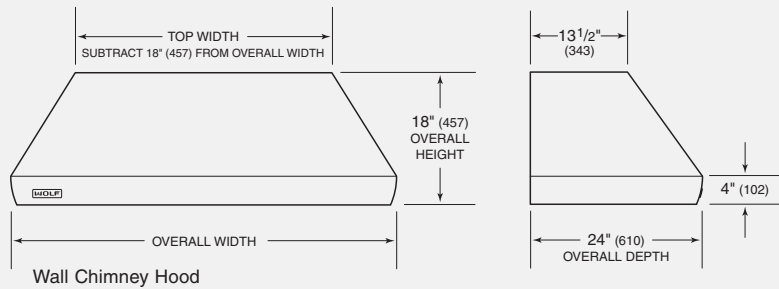

Wall Chimney Hood

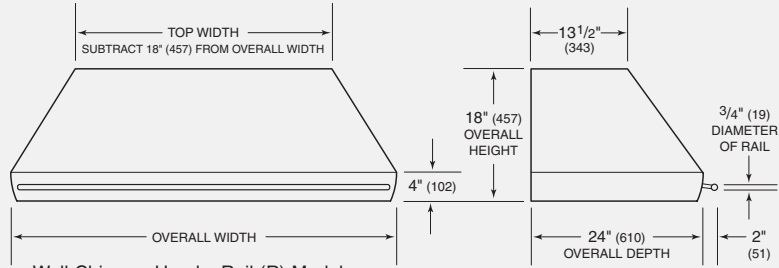

Wall Chimney Hood—Rail (R) Model

Unit dimensions may vary by  $\pm 1/8"$ .

### Specifications

|                              |   |
|------------------------------|---|
| Exterior Finish              | Classic Stainless Steel                         |
| Overall Widths               | 36", 42", 48" and 54"                           |
| Overall Height               | 18"   |
| Overall Depth                | 24"   |
| (including rail)             | 26"   |
| Bottom of Hood to Countertop | 30" to 36"                                      |
| Discharge                    | Vertical  |
| Duct Size                    | 10" Round                                       |
| Electrical Requirements      | 110/120 V AC<br>60 Hz, 15 amp dedicated circuit |
| Shipping Weight              | 78–106 lbs                                      |

### Installation Specifications

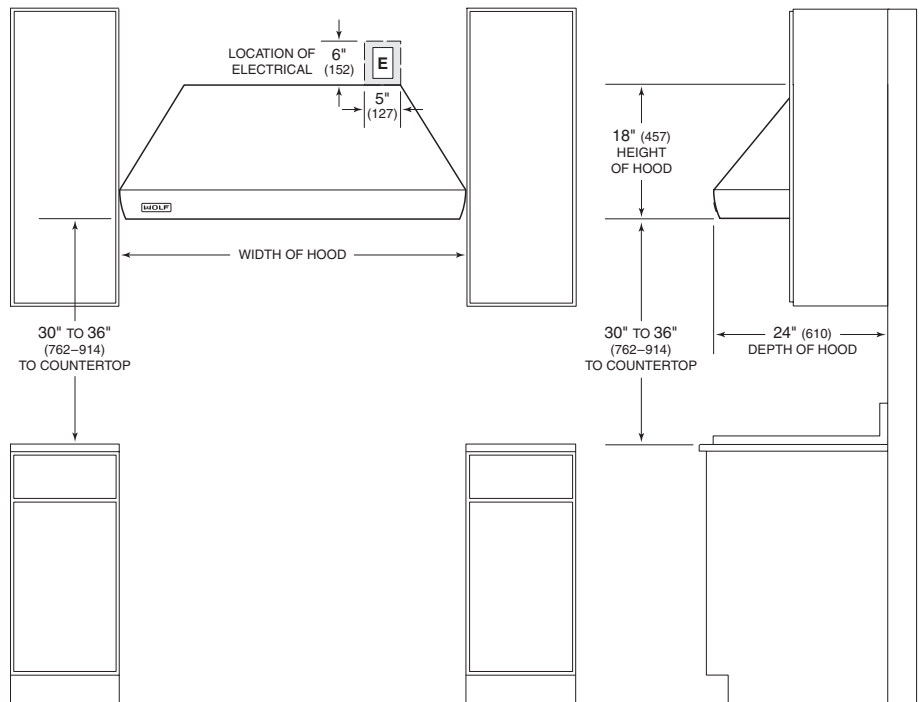

NOTE: Pro wall chimney hoods have a vertical discharge.

### Installation Notes

Pro wall chimney hoods are sold as a shell only. An internal, in-line or remote blower is required. For blower recommendations, visit our website, [wolfappliance.com](http://wolfappliance.com).

**IMPORTANT NOTE:** Pro wall chimney ventilation hoods are recommended for use with all Wolf cooking appliances. For optimal performance, a Pro 27" deep wall hood is recommended for use with ranges and rangetops that contain a charbroiler or griddle.

Dimensions in parentheses are in millimeters unless otherwise specified.