



**Model WWD30
Warming Drawer**

The superior air control of the Wolf warming drawer helps keep moist foods moist and crisp foods crisp. Model WWD30 can be used in combination with a Wolf built-in oven and/or microwave. Stainless steel drawer fronts match the look of our L Series and E Series ovens and the integrated drawer front allows for a custom wood panel. Electronic controls are hidden so the unit integrates with surrounding cabinetry.



Model WWD30 shown with L Series classic stainless steel drawer front.

Features

- L Series stainless steel drawer front with handle available in classic, platinum and carbon finishes
- E Series stainless steel drawer front with handle available in classic finish
- Integrated drawer front allows for custom wood panel application
- 850-watt heating element
- Hidden electronic touch control panel
- Preset and variable temperature control
- Preset automatic shut-off or extended operation in Sabbath Mode
- Stainless steel interior
- Rack for stacking food
- Removable stainless steel drawer pan
- Full-extension, ball bearing drawer glides
- Approved for outdoor installations

Drawer Front Finishes

L Series stainless steel drawer front available in three finishes—E Series in classic only.

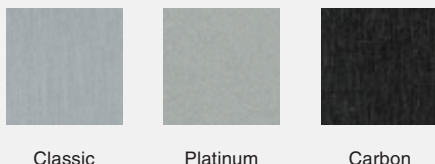

Classic

Platinum

Carbon

30" L Series Drawer Front	WWDFRONT/S	WWDFRONT/P	WWDFRONT/B
Stainless Steel Finish	Classic	Platinum	Carbon
30" E Series Drawer Front	WWDFRONT-2F/S	WWDFRONT-2U/S	
Stainless Steel Finish	Framed/Classic	Unframed/Classic	
Integrated Drawer Front	WWDFRONT/I		
Accepts Wood Panel	■		

Model WWD30 is sold as a base unit only. A drawer front panel is required. Panels are available through your Wolf dealer. Stainless steel drawer front panels include a handle to match L Series or E Series built-in ovens. Integrated drawer front allows for a custom wood panel and handle hardware.

Accessories

- Tubular handle for integrated drawer front in classic, platinum or carbon stainless steel
- Classic stainless steel handle for integrated drawer front to match E Series ovens
- Six-piece container set—includes six stainless steel pans with lids: one 6.7-quart pan, one 4.1-quart pan, two 3-quart pans, two 1.8-quart pans and pan rack



L Series Drawer Front (carbon stainless shown)

E Series Drawer Front



Integrated Drawer Front

Accessories are available through your Wolf dealer. To obtain local dealer information, visit the Showroom Locator section of our website, wolfappliance.com.

 This appliance is certified by Star-K to meet strict religious regulations in conjunction with specific instructions found on www.star-k.org.



Accessory Container Set



**Model WWD30
Warming Drawer**

Overall Dimensions

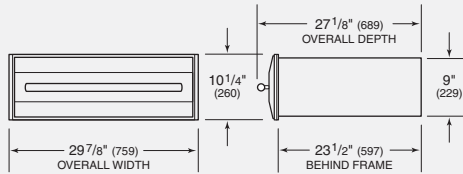

Model WWD30 with L Series drawer front

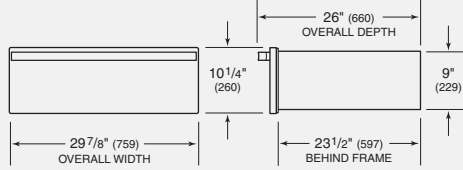

Model WWD30 with E Series drawer front

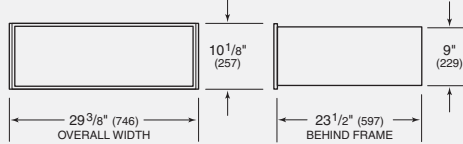

Model WWD30 with integrated drawer front

Unit dimensions may vary by ± 1/8".

Specifications

Model WWD30 with L Series Drawer Front	
Overall Width	29 ⁷ / ₈ "
Overall Height	10 ¹ / ₄ "
Overall Depth (including handle)	27 ¹ / ₈ "
Model WWD30 with E Series Drawer Front	
Overall Width	29 ⁷ / ₈ "
Overall Height	10 ¹ / ₄ "
Overall Depth (including handle)	26"
Model WWD30 with Integrated Drawer Front	
Overall Width	29 ³ / ₈ "
Overall Height	10 ¹ / ₈ "
Overall Depth (behind frame)	23 ¹ / ₂ "
Integrated Panel Dimensions (min)	
Overlay	30" W x 10 ³ / ₈ " H
Inset	29 ³ / ₈ " W x 10 ¹ / ₈ " H
Integrated Panel Thickness (min)	5/8"
Integrated Panel Weight (max)	25 lbs
Heating Element	850 W
Electrical Requirements	120 V AC, 60 Hz 15 or 20 amp circuit
Power Cord	3' cord with grounded plug
Shipping Weight	100 lbs

Installation Specifications

Installation with L Series drawer front

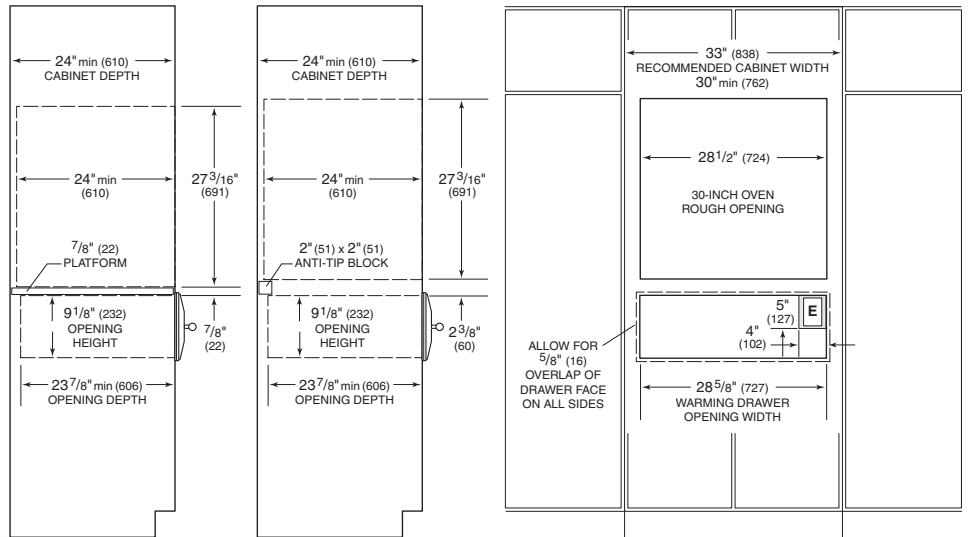

PLATFORM APPLICATION

ANTI-TIP BLOCK APPLICATION

NOTE: Refer to the 30" (762) L Series built-in oven specifications for electrical location.

Installation Notes

Installation with L Series drawer front shown—specifications for E Series and integrated drawer fronts will vary.

Model WWD30 is sold as a base unit only. It must be installed with an accessory drawer front. Specifications will vary with each drawer front. Refer to installation instructions provided with the drawer front. Complete installation specifications can be found on our website, wolfappliance.com.

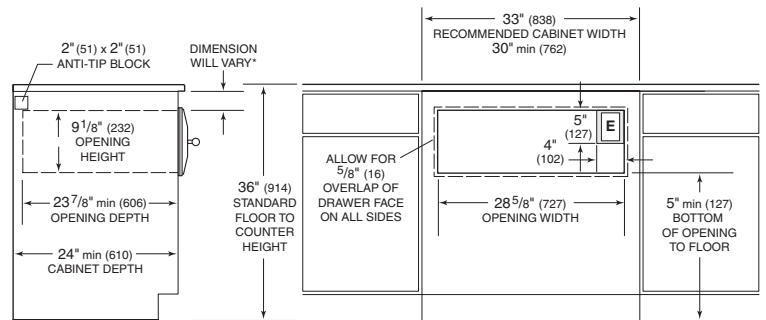

*Allow enough room for placement of anti-tip block and drawer face overlap.

Dimensions in parentheses are in millimeters unless otherwise specified.